

Cusworth Park Tree Trail

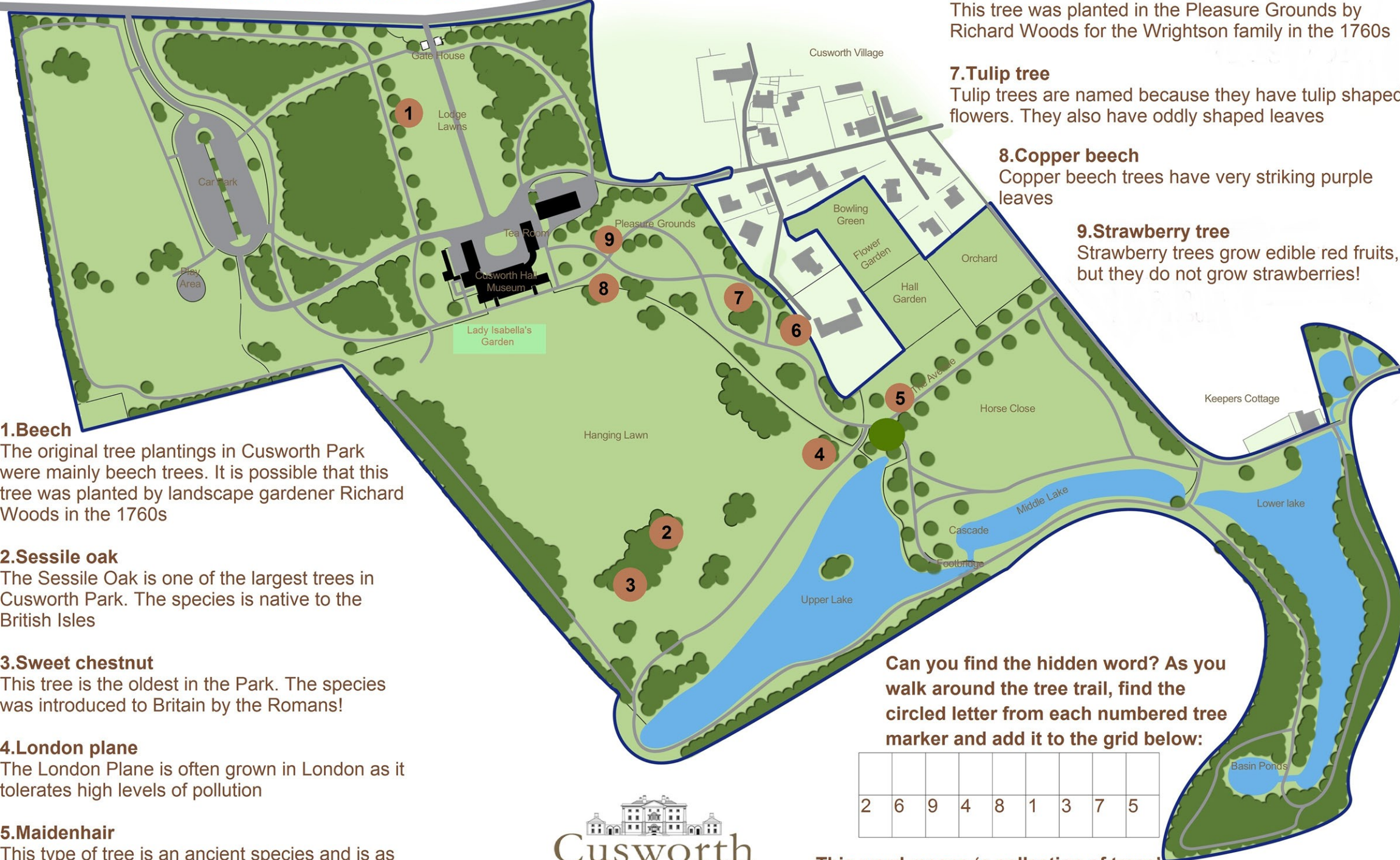

6. Cedar of Lebanon
This tree was planted in the Pleasure Grounds by Richard Woods for the Wrightson family in the 1760s

7. Tulip tree
Tulip trees are named because they have tulip shaped flowers. They also have oddly shaped leaves

8. Copper beech
Copper beech trees have very striking purple leaves

9. Strawberry tree
Strawberry trees grow edible red fruits, but they do not grow strawberries!

1. Beech
The original tree plantings in Cusworth Park were mainly beech trees. It is possible that this tree was planted by landscape gardener Richard Woods in the 1760s

2. Sessile oak
The Sessile Oak is one of the largest trees in Cusworth Park. The species is native to the British Isles

3. Sweet chestnut
This tree is the oldest in the Park. The species was introduced to Britain by the Romans!

4. London plane
The London Plane is often grown in London as it tolerates high levels of pollution

5. Maidenhair
This type of tree is an ancient species and is as old as the dinosaurs!

Can you find the hidden word? As you walk around the tree trail, find the circled letter from each numbered tree marker and add it to the grid below:

| | | | | | | | | |
|---|---|---|---|---|---|---|---|---|
| | | | | | | | | |
| 2 | 6 | 9 | 4 | 8 | 1 | 3 | 7 | 5 |



This word means 'a collection of trees'